

used for: DIN EN 60603 TYPE "F"

SEE NOTE 3

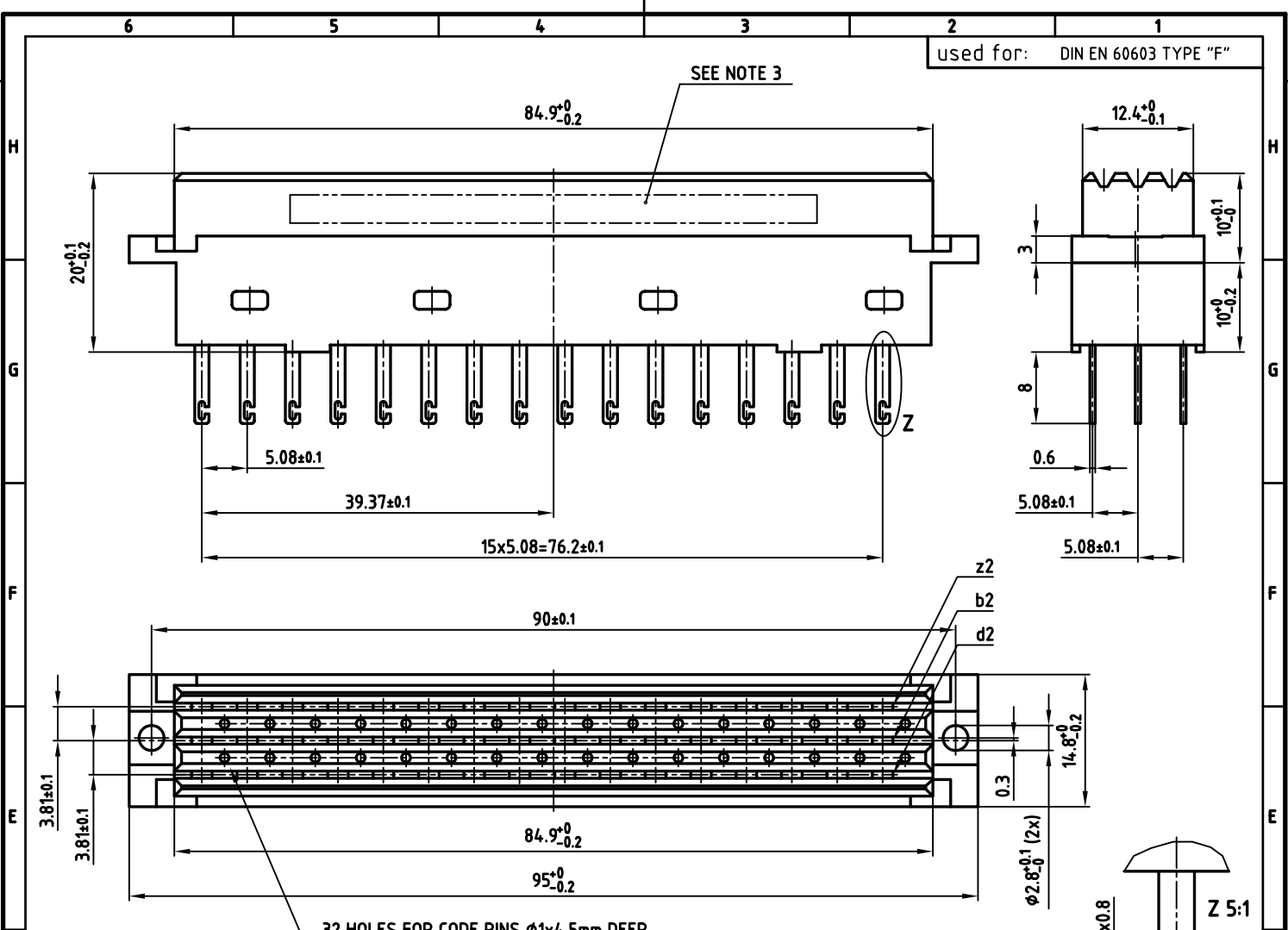

NOTES:

1. INSULATOR: PBT GF UL 94 V-0; GREY
2. CONTACTS: COPPER ALLOY
PLATING: GOLD OVER NICKEL
50 MATING CYCLES
3. CONNECTOR IS PART MARKED: 122A11119X CONEC ABC

Directive 2002/95 EC
"RoHS"
Compliant

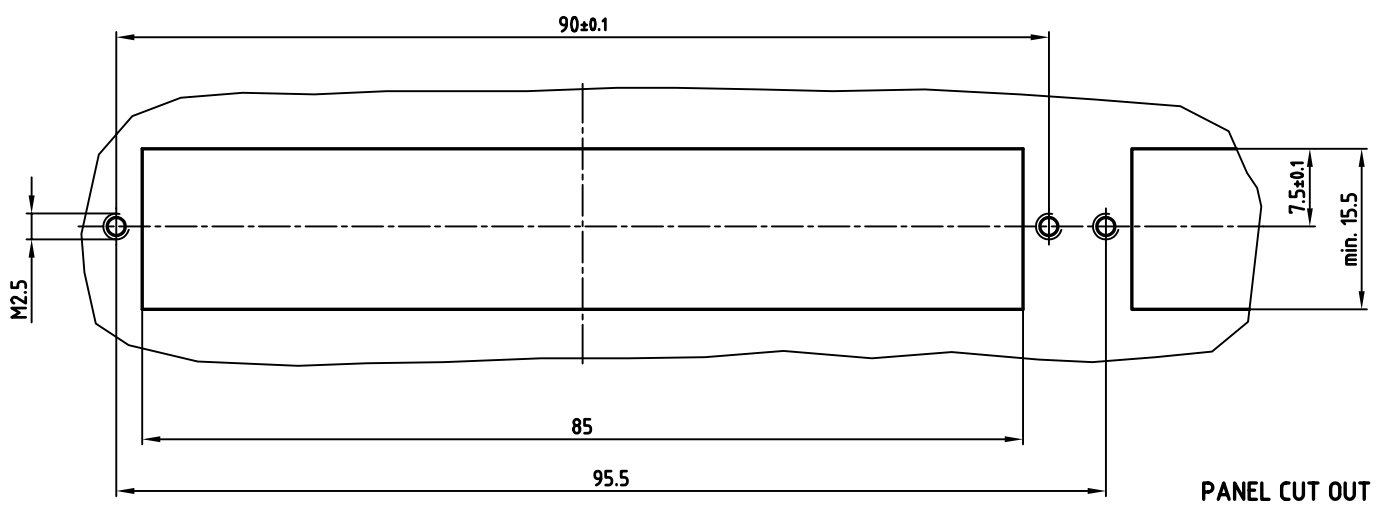
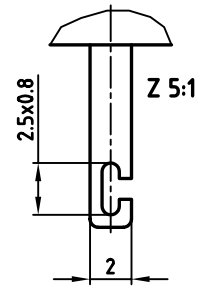

APPROVAL # FREIGABE # DEBLOCAGE # AUTORIZACION # APPROVAL	
CUSTOMER APPROVAL DATE:	
NAME:	TITLE:
COMPANY NAME:	
APPROVAL # FREIGABE # DEBLOCAGE # AUTORIZACION # APPROVAL	

THIS DRAWING MAY NOT BE COPIED OR REPRODUCED IN ANY WAY, AND MAY NOT BE PASSED ON TO A THIRD PARTY, WITHOUT WRITTEN PERMISSION. OWNERSHIP AND COPYRIGHT OF CONEC Gmbh DO NOT ALTER CAD DRAWING BY HAND			
rev.	description	date	name

tolerance		scale: 2:1 (5:1)	
dim. in mm		material: SEE NOTES	
2004	date	title:	
drawn	14.07.	Lehmenkühler	
appd.	14.07.	Mickenbecker	
norm: DIN EN 60603		dwg no: AutoCAD 2004	
d-old		DIN-A	
CONEC		12K1A314	
		part no: 122A1119X	
		sh: 1/1	